

# QUICK PROGRAMMING GUIDE FOR ALL RTS MOTORS

ALTUS RTS 120 V / SONESSE 30™ 24V / WIREFREE™ ROLL UP LT-30RT ROUND HEAD and CORD LIFT CT-32 MOTORS

PLEASE REFER TO INDIVIDUAL INSTRUCTIONS FOR MORE DETAILS

## Programming Mode

### Before you begin

Motors are shipped without limit settings and transmitter ID's.

Steps 1 to 7 must be completed to ensure proper shade programming and functionality.

It is recommended to power only the motor being programmed (disconnect power to all the other motors)

Motor will exit programming mode after 2 minutes of inactivity.

### STEP 1: Connect power

With the motor installed in shade connect power to the motor (120V, or 12 V or 24V transformer or 12 V battery wand)



### STEP 2: Initiate programming

Press both and at the same time until the motor jogs.

**A jog is a brief up and down motion**

In programming mode the motor operates in momentary fashion.



### STEP 3: Check directions

Press or

When pressing product should go down or out.

To change direction press and hold (Stop) until the motor jogs (shade has a short up and down movement)



### STEP 4: Set the limits

Bring the motor to desired **upper** limit. Press both (Stop) and until the motor moves, then release. (if the motor stops when the buttons are released take it back to the upper limit and repeat) Stop the motor when reaching the desired **lower** limit. You can adjust by pressing or



### STEP 5: Set the limits

Press both (Stop) and at the same time until the motor moves, then release. The motor will stop at the original upper limit.



### STEP 6: Confirm limit settings

Press and hold (stop) until the motor jogs to confirm the limit settings.



### STEP 7: Set user mode

Press and hold the programming button on the back of the transmitter until the motor jogs. It will now operate in a maintained fashion (user mode). Double check limit settings as a precaution.

## Adjusting the limits in User Mode

### To change the lower limit

Send the motor to it's current lower limit.

Press both and at the same time until the motor jogs

Adjust to a new lower limit position.

Press until the motor jogs



### To change the upper limit

Send the motor to it's current upper limit.

Press both and at the same time until the motor jogs.

Adjust to a new upper limit position.

Press until the motor jogs



## Setting an Intermediate Position

### SETTING

Send the shade and stop it at the desired intermediate position by pressing (Stop)

Once the desired Intermediate position is reached, Press and hold (stop) until the shade jogs. The Intermediate position is now added to memory



### USING

Send the shade to the intermediate position by pressing (stop) from ANY shade position..

Note: Shade should be stationary prior to activating intermediate position function.



### NOTE

If shade is actively moving (in-motion) Should be pressed twice.

To Delete: Activate shade to intermediate position, then press and hold (stop) for 5 seconds. Shade will jog to confirm deletion.

somfy®

## Adding or deleting a Transmitter or a Channel



### STEP 1:

Using already programmed transmitters select the transmitter (single channel) or the channel, (1-5) of a multi-channel transmitter.

### STEP 2:

Press and hold the programming button of that transmitter until the motor jogs.



### STEP 3:

Select the transmitter (single channel) or the channel, (1-5) of a multi-channel transmitter, to be added or deleted.

### STEP 4:

Press and hold the programming button of that transmitter until the motor jogs.

## Resetting WIREFREE™ ROLL UP MOTORS LT-30RT ROUND HEAD

**To delete all previous settings:** Using a paper clip, press and hold the PROGRAM button located on the motor head. The LED will light then blink; release the button when the LED turns off. If you cannot see the LED, push the programming button for 15 seconds, and then release the button. All transmitters and limits will be erased. (Motor is now reset to factory mode). Motor limits will need to be reestablished.

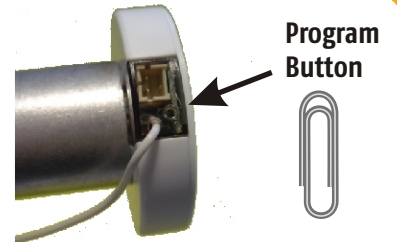

## Resetting WIREFREE™ CORD LIFT MOTORS CT-32

**To delete all previous settings:** press and hold the **PROGRAM** button (approximately 15 seconds) until the LED blinks rapidly then extinguishes. All transmitters and limits will be erased. (Motor is now reset to factory mode). Motor limits will need to be reestablished.

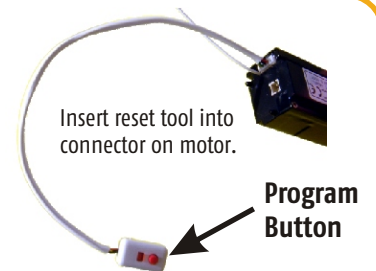

## Resetting SONESSE 30™ 24V

**To delete all previous settings:** Using a paperclip, press and hold the red **PROGRAM** button (approximately 15 seconds) until the motor jogs 3 times. All transmitters and limits will be erased. (Motor is now reset to factory mode). Motor limits will need to be reestablished.

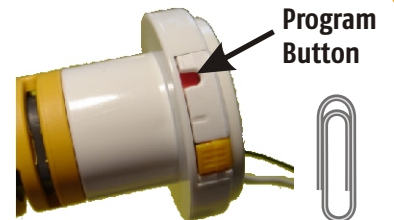

## Resetting Altus RTS 120 V

Perform a Dual Power Cut to delete all previous settings



2 Seconds

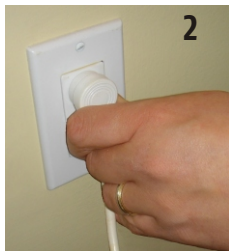

10 Seconds



2 Seconds





Motor starts to move.

5 When the motor stops press and hold the programming button of any transmitter until the motor jogs **twice**.

Do not release the programming button until the jogging is complete or you will have to start the dual power cut from the beginning.



## Activating Step (Tilting) Feature for Sheer Shade Applications (With WIREFREE™ ROLL UP MOTORS LT-30RT ROUND HEAD ONLY)

- 1) Press , shade will travel to pre-set DOWN limit.
- 2) Press and hold  until shade begins to "step" or tilt.
- 3) Release  once new position is reached.