

## Dependable Security for Wide Openings

### WIDE COVERAGE

Provides versatile security solution for openings up to 30 ft. wide.

### STRIKING AESTHETICS

Tubular motor and box housing provide compact, below ceiling installations to match interior architecture needs.

### PUNCHED VISIBILITY

Punched options to maximize visibility while ensuring security.

### ENGINEERED DURABILITY

Double rail and washer retention system ensure smooth, repeatable operation at the largest widths.

### RAPID INSTALLATION

Developed for rapid 2-hr (typ) installation for below ceiling configurations.

# Features Summary

## TUBULAR MOTOR OPERATOR

- 54 - 312 in. (width) (4 ft., 6 in. - 26 ft.)
- 30 - 168 in. (height) (2 ft., 6in. - 14 ft.)

## JACKSHAFT OPERATOR

- 54 - 360 in. (width) (4 ft., 6 in. - 30 ft.)
- 30 - 216 in. (height) (2 ft., 6in. - 18 ft.)

## SLATS

- Solid single wall extruded 6063-T6 aluminum
- Retained in curtain with carbon steel screws, and washers
- Punched configurations for visibility and airflow

## GUIDE RAILS

- 6063-T6 Aluminum lined with polypropylene runners and felts.
- Double depth configuration with L-bracket support structure

## BOTTOM BAR (BASE SLAT)

- Re-enforced, wide-span (motorized)

## BOX HOUSING

- 10-gauge carbon steel in 12 in. size (tubular operator)
- Custom 17 in. or other sizes available (jackshaft operator)

# Options Summary

## BOX HOUSING SHAPE

- 45° for tubular motor
- 90° or custom for jackshaft motor

## OPERATOR

- Tubular motor (override)
- Jackshaft motor (multiple options)

## LOCKS

- Motor brake locking provides security for entire system

## COLORS

- White and custom. Powder and wet paint.
  - SH - Series powder coat per AAMA 2603-13, DFT 60-110µm
  - H/S Polyester 221T2602 Dura Coat wet paint DFT 24-28µm
- Clear (silver) anodize (Type II, Class 2, 10µm)

## MOUNT

- Surface mount to existing structure
- Jamb mount (typical) to installed 3x3 or 4x4 aluminum or steel tubes with associated floor brackets and slip joints

## WARRANTY



\*Applies to commercial applications only and customers who follow Use and Care Guidelines

# System Details (Slats And Curtain Configuration)

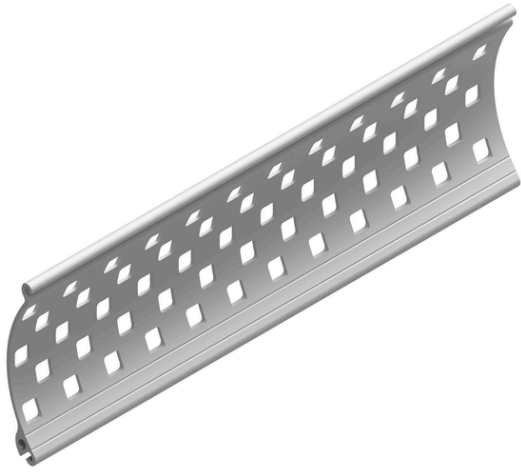

(Punched, Ref)

- System designed around an end-retained standard slat.
- Optimized hook and receiver for strength and durability over wide spans

## XL Elevation Motorized

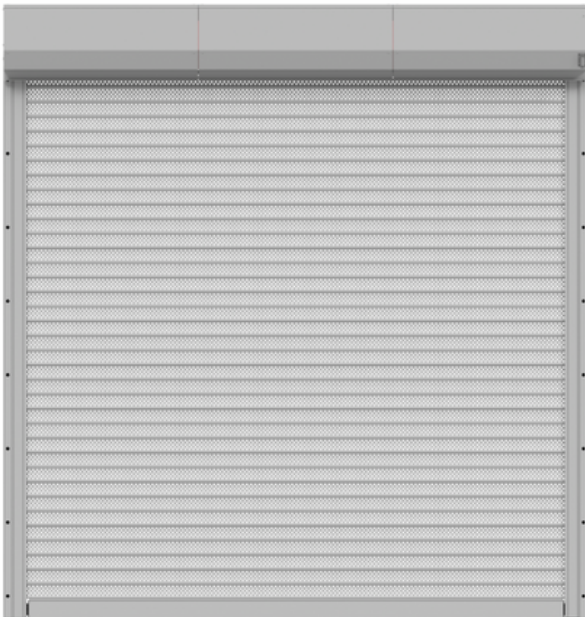

- Consistent slat configuration throughout curtain
- Motorized only, no finger pull or supplemental lock slats
- Base slat optimized for strength and rigidity at wide spans
- Top-of-box to clear varies with housing and motor type (12 in. standard, custom, or no-cover configurations)

# System Details (Rails)

## Retained Rail With Snap Cover (Motorized)

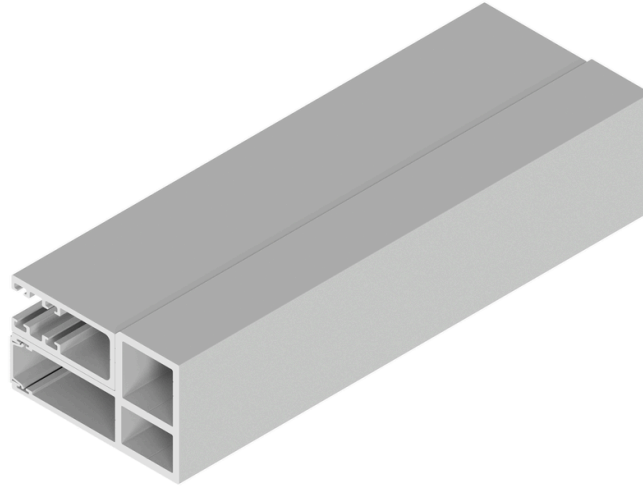

(4-1/2 in. (W) x 2-5/8 in. (D))

Double-rail design optimized for strength and operating performance over wide spans

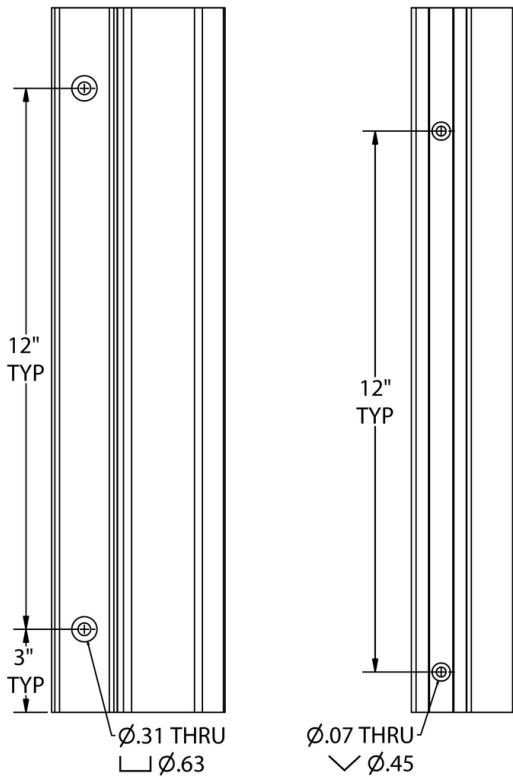

Holes pre-drilled for ease of installation

On-center distance and hole pattern vary by application requirement (W x H)

Holes are drilled every 12" in both the bracket carrier buildout and rail throat

# Option Details (Punch Patterns)

## Primary

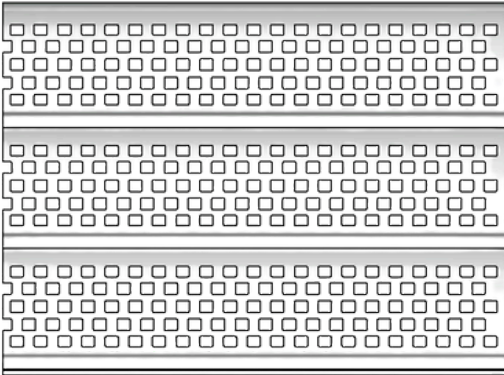

Punch 51 (P51)

- High-visibility punch pattern typically used for storefront and interior/counter applications
- Provides strength and visibility
- Maximum width 30 ft.

## Secondary / Specialty (Limited)

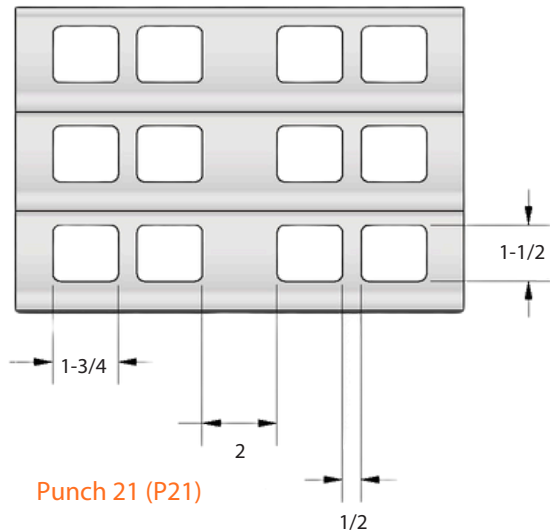

Punch 21 (P21)

- Medium opening pattern used for both interior store front and counter installations
- Hole patterns centered left-to-right on slat for maximum visual continuity
- Maximum width 16 ft. to ensure strength

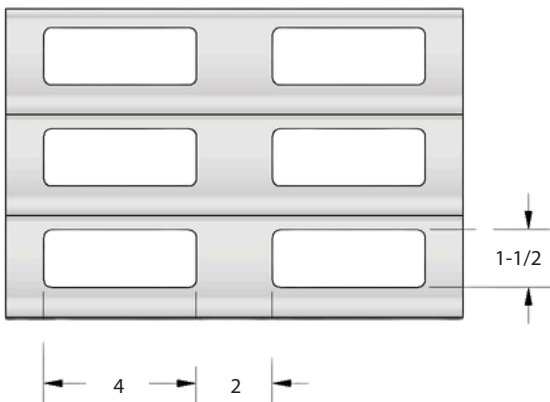

Punch 11 (P11)

- Large hole pattern used where high airflow required
- Primarily used for specialty applications
- Hole pattern centered left-to-right on slat to maximize visual continuity
- Maximum width 16 ft. to ensure strength

# Option Details (Box Housing)

## 45° Housing

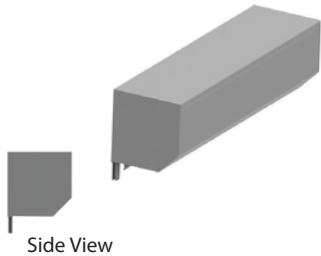

## Custom Housing



Limited to 45° housing as standard, but can support custom housings for unique applications or jackshaft tubular requirements

## Cable Locations

### WIRE LOCATIONS:

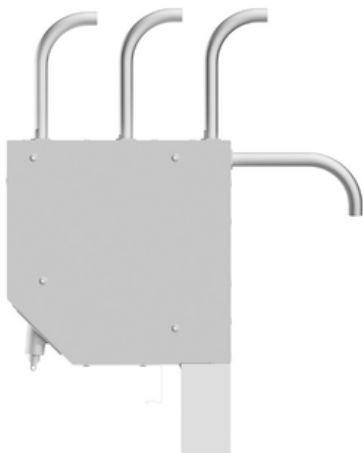

Motor power cables can exit housing assembly in multiple locations

(Typ: Reference Housing Detail)

Shutter system provides flexibility in power and pole locations to aid in installation and optimize aesthetics across various opening and mounting types.

# Option Details (Locks)

## General Base Slat

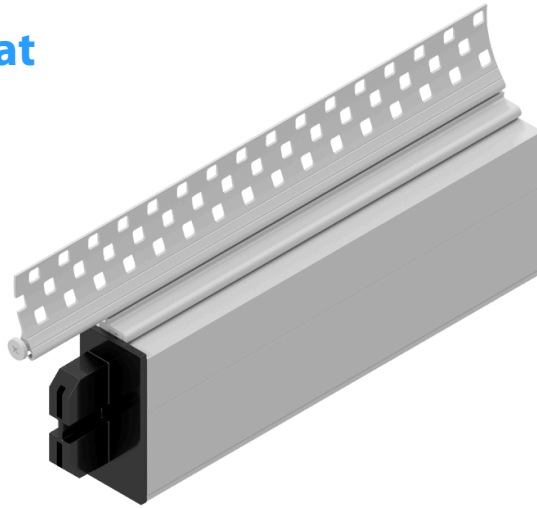

Bulb Seal



Finseal

Re-enforced motorized base slat provides strength for wide spans. Range of bottom-seal options for floor or counter applications

## Operators



### TUBULAR MOTOR (WIRED)

Small-footprint motor system with wall or keyswitch activation for day-today reliability



### JACKSHAFT (BELT DRIVE)

Standard-drive jackshaft system with wall or key switch activation



### JACK SHAFT (GEAR DRIVE)

Compact, worm gear drive jackshaft system with wall or key switch activation

## Colors and Finish



Clear Anodized  
(Silver)



White



Custom

Powder coat and wet paint options for both standard and custom colors are available.

Contact your QMi Sales or Project Support Representative for pricing and lead times on custom color options.

# Mounting Details



System designed for rapid stand-up and mounting to a range of substrates below and above the ceiling

## Surface Mount

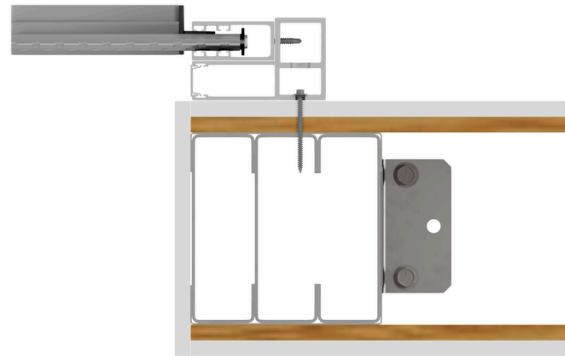

Surface mounted to structure. Structure provided by others. (QMi Application Engineering Support)

## Jamb Mount

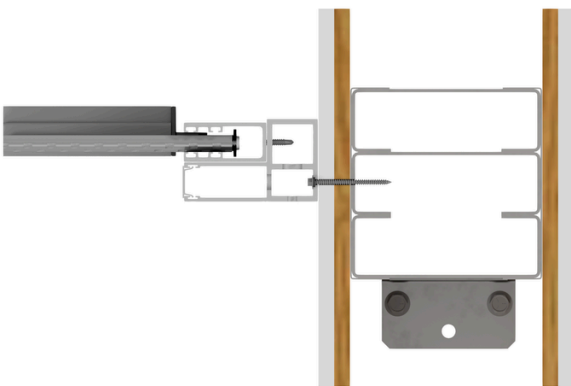

Jamb mounted between two (2) structure walls. Structure provided by others. (QMi Application Engineering Support)

## Surface Mount (Other)

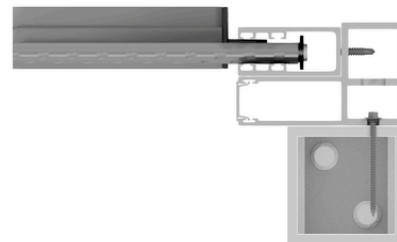

Surface-mounted to QMi provided 3x3 or 4x4 ft. structure buildout with floor brackets